

Current part is item (4) on diagram. Available at www.oshkoshequipment.com

(1) (a) FIG. NO.	(2) (b) ITEM NO.	(3) SMR CODE	(3) NATIONAL STOCK NUMBER	(4) PART NUMBER	(5) FSCM	(6) DESCRIPTION USABLE ON CODE	(7) U/M	(8) INC IN UNIT
0311-ENGINE STARTING AIDS								
36	1	PAOZZ	5330-00-899-4484	10889772	19207	GASKET: HEATER MTG TO ELBOW AB,AC	EA	1
36	2	PAOOO	2990-00-860-2339	7748871	19207	HEATER ASSEMBLY,FLAME: INTAKE MANIFOLD AB,AC	EA	1
36	3	XAOZZ		10912590	19207	HOUSING ASSEMBLY: HEATER AB,AC	EA	1
36	4	PAOZZ	5330-00-298-0091	150190	21450	GASKET: SPARK PLUG AB,AC	EA	1
36	5	PAOZZ	2920-00-411-5747	10935558	19207	SPARK PLUG: FLAME HEATER AB,AC	EA	1
36	6	PAOZZ	2990-00-119-3915	11641827	19207	NOZZLE AND VALVE: FLAME HEATER AB,AC	EA	1
36	7	PAOZZ	4730-00-430-3165	119922	21450	BUSHING,PIPE HEATER CONNECTOR AB	EA	1
36	8	PAOZZ	5340-00-792-0843	11641634	19207	CLAMP,LOOP: IGNITION UNIT MTG AB,AC	EA	2
36	9	PAOZZ	5310-00-407-9566	MS35338-45	96906	WASHER,LOCK: FLAME HEATER AND CLAMP MTG TO ELBOW AB,AC	EA	4
36	10	PAOZZ	5310-00-880-7744	MS51967-5	96906	NUT,PLAIN,HEXGON: FLAME HEATER AND CLAMP MTG TO ELBOW AB,AC	EA	4
36	11	PAOZZ	2990-00-927-9384	11588687	19207	IGNITION UNIT: FLAME HEATER AB,AC	EA	1
36	12	PAOZZ	2920-00-961-1303	10935158	19207	LEAD AND CONDUIT ASSEMBLY: IGNITION UNIT TO HEATER AB,AC	EA	1
36	13	PAOZZ	2990-00-119-3918	10889785	19207	BRACKET: FLAME HEATER AB,AC	EA	1
36	14	PAOZZ	5305-00-269-3213	MS90725-62	96906	SCREW,CAP,HEXAGON HEAD: BRACKET TO CRANKCASE AB,AC	EA	3
36	15	PAOZZ	5310-00-061-1258	MS45904-76	96906	WASHER,LOCK: BRACKET TO CRANKCASE MTG AB,AC	EA	3
36	16	PAOZZ	5305-00-614-0248	MS35266-66	96906	SCREW,MACHINE: PUMP TO BRACKET MTG AB,AC	EA	2
36	17	PAOZZ	2910-00-860-2338	7748874	19207	PUMP,FUEL,ELECTRICAL: HEATER AB,AC	EA	1
36	18	PAOZZ	5310-00-934-9751	MS35650-302	96906	NUT,PLAIN,HEXAGON: PUMP MTG TO BRACKET AB,AC	EA	2
36	19	PAOZZ	5310-00-080-9786	MS45904-60	96906	WASHER,LOCK: PUMP TO MTG TO BRACKET AB,AC	EA	2
36	20	PAOZZ	4730-00-570-2934	10914557	19207	UNION: PUMP TO TUBE AB,AC	EA	1
36	21	MOOZZ		11609977-3	19007	TUBE,PLASTIC: PUMP TO NOZZLE (MFD FROM TUBE,NSN 4720-00-010- 9801) AB,AC	EA	1
36		PAOZZ	4730-01-047-2605	11682596	19207	BUSHING SLEEVE: EACH END OF TUBE(11609977-3) AB,AC	EA	V
36	22	PAOZZ	4730-00-078-9773	10914552	19207	ELBOW,PIPE TO TUBE: PUMP TO HEATER AB,AC	EA	1
37	1	MOOZZ		11609976-3	19207	TUBE,PLACTIC: SOLENOID TO PUMP(MFD FROM TUBE NSN 4720-00-135-4424) AB,AC	EA	1

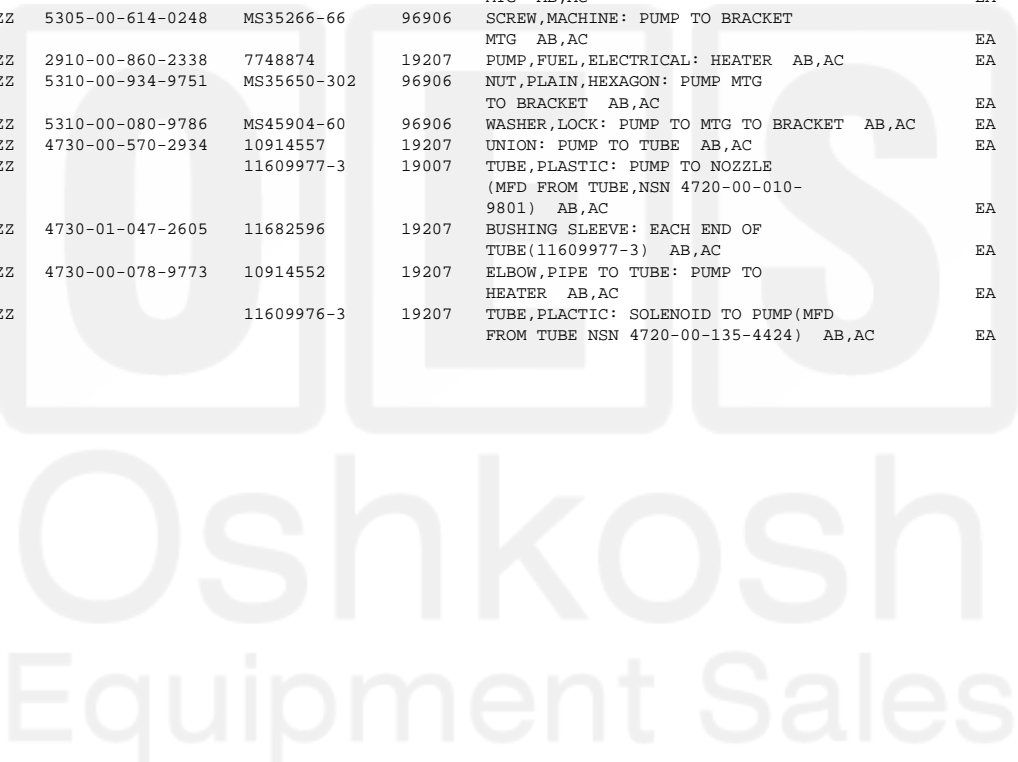

Current part is item (4) on diagram. Available at www.oshkoshequipment.com

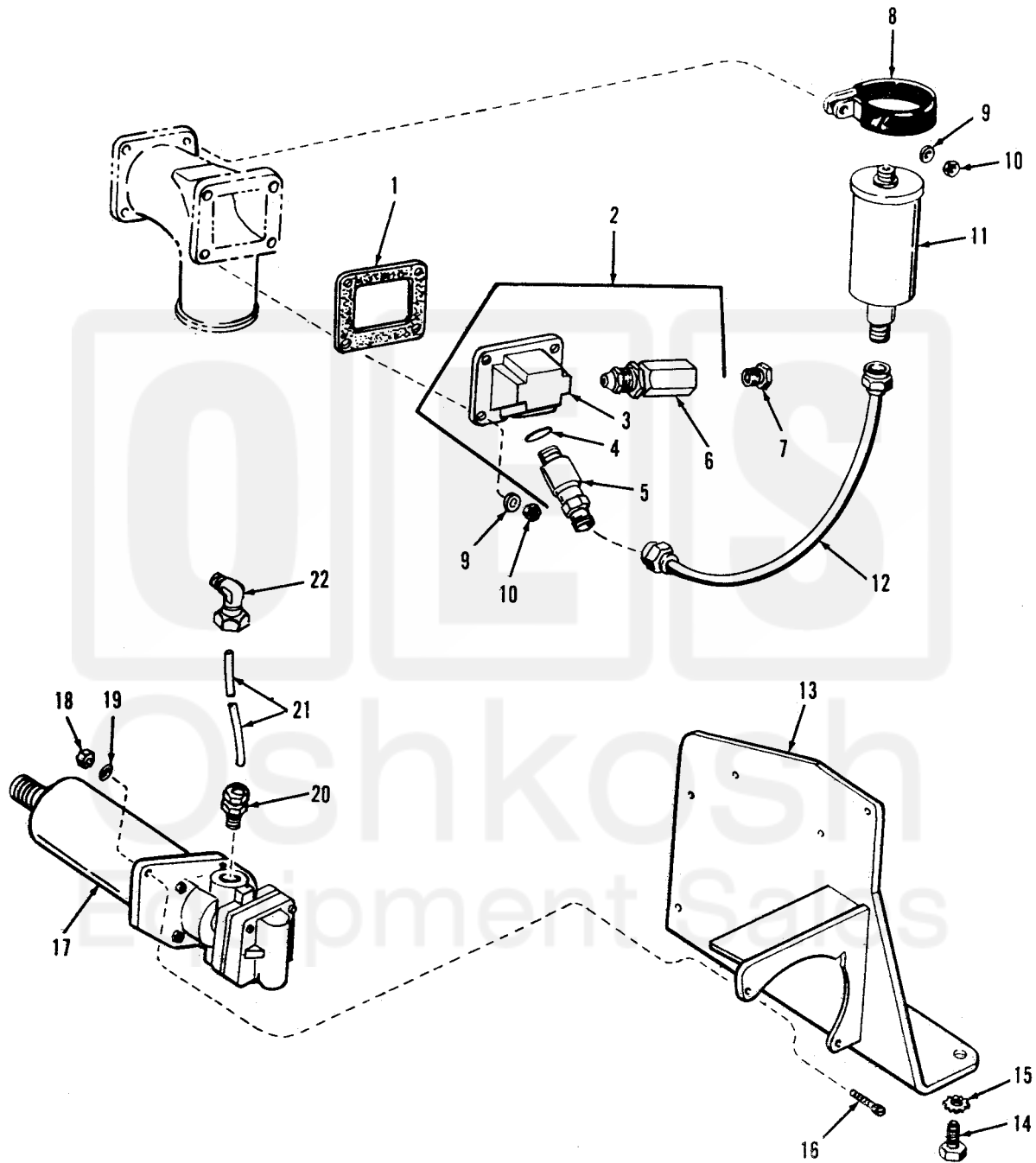

Figure 36. Flame heater, ignition unit and fuel pump.

TA 031514